

## vögtlin flow studio Quick Start Guide

# vögtlin flow studio

## Our single software solution

# Table of contents

<b>1. Introduction to vögtlin flow studio .....</b>	<b>3</b>
1.1 System Requirements.....	3
<b>2. Installation Process .....</b>	<b>4</b>
<b>3. User Interface .....</b>	<b>5</b>
3.1 Main Workspace: .....	5
3.2 Home Menu.....	6
3.3 Device Manager Menu .....	7
3.4 Graph Tool Menu .....	9
3.5 Data Logger Menu .....	10
<b>4. Connect Devices in two steps .....</b>	<b>11</b>
<b>5. Updating of vögtlin flow studio .....</b>	<b>15</b>
<b>6. FAQs and troubleshooting.....</b>	<b>16</b>
6.1 Windows Defender blocks installation .....	16
<b>7. Appendix.....</b>	<b>16</b>
7.1 Copyright and Liability Disclaimer .....	16
7.2 Contact information .....	16
7.3 History change document .....	17

# 1. Introduction to vögtlin flow studio

**vögtlin flow studio** our single software solution for configuration, analysis, control and data recording of all Vögtlin instruments - all combinable in one overview



successor of [get red-y Software](#)

## Key features of the current vögtlin flow studio software

**One application for all devices at the same time:** d-flux, red-y\* family series

- **Device Manager:** Add and configure your devices according to your needs, allowing you to monitor and control process data in real time.
- **Graph Tool:** Visualize selected process data of your devices, all combinable in one overview
- **Data Logger:** Monitor and record selected process data of your devices and export them as an Excel Sheet.



*\*Please note that version 1.03 is especially useful for d-flux users. The red-y family series can be used as well with vögtlin flow studio, with limited functionalities compared to our legacy get red-y software. New functionalities will be made available in future updates*

## 1.1 System Requirements

**Operating System:** Compatible with Microsoft Windows 7SP1, 8/8.1, 10, and Windows 11

**Hardware:** serial ports (build-in, USB dongle or virtual COM port)



**Additional Requirements:** With an Internet connection, vögtlin flow studio automatically informs you of new software updates.

## 2. Installation Process

### Step 1: Download

Visit [www.voegtlin.com](http://www.voegtlin.com) website and download vögtlin flow studio from our software page.

### Step 2: Run Installer

Open the downloaded ZIP file: **voegtlin flow studio Setup 1.0.X.exe**, and follow the on-screen instructions to install the software.



**NOTE:** In case you would get the message **Windows protected your PC**, as shown below just click "More info" and then select "Run anyway".

(for more details read our FAQs and troubleshooting below in this document)



### Step 3: Setup and install

complete the initial setup wizard and launch the software.

# 3. User Interface

## 3.1 Main Workspace:

Centralized area, currently defined by 5 menus, where users interact with their devices and data, view graphs, and record information, but also customizes software settings.



Depending on the window size, the menus will appear in various forms.

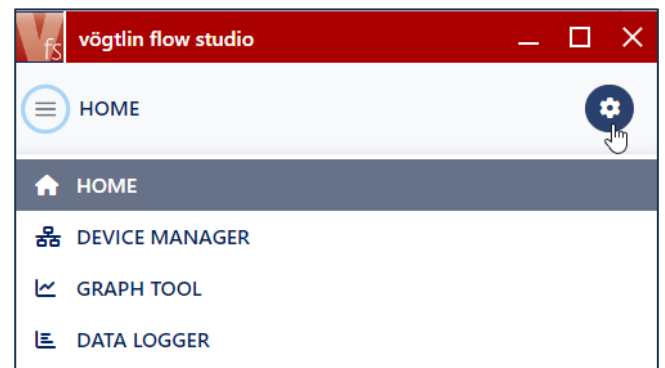

**Figure 1:** menu bar by reduced window size

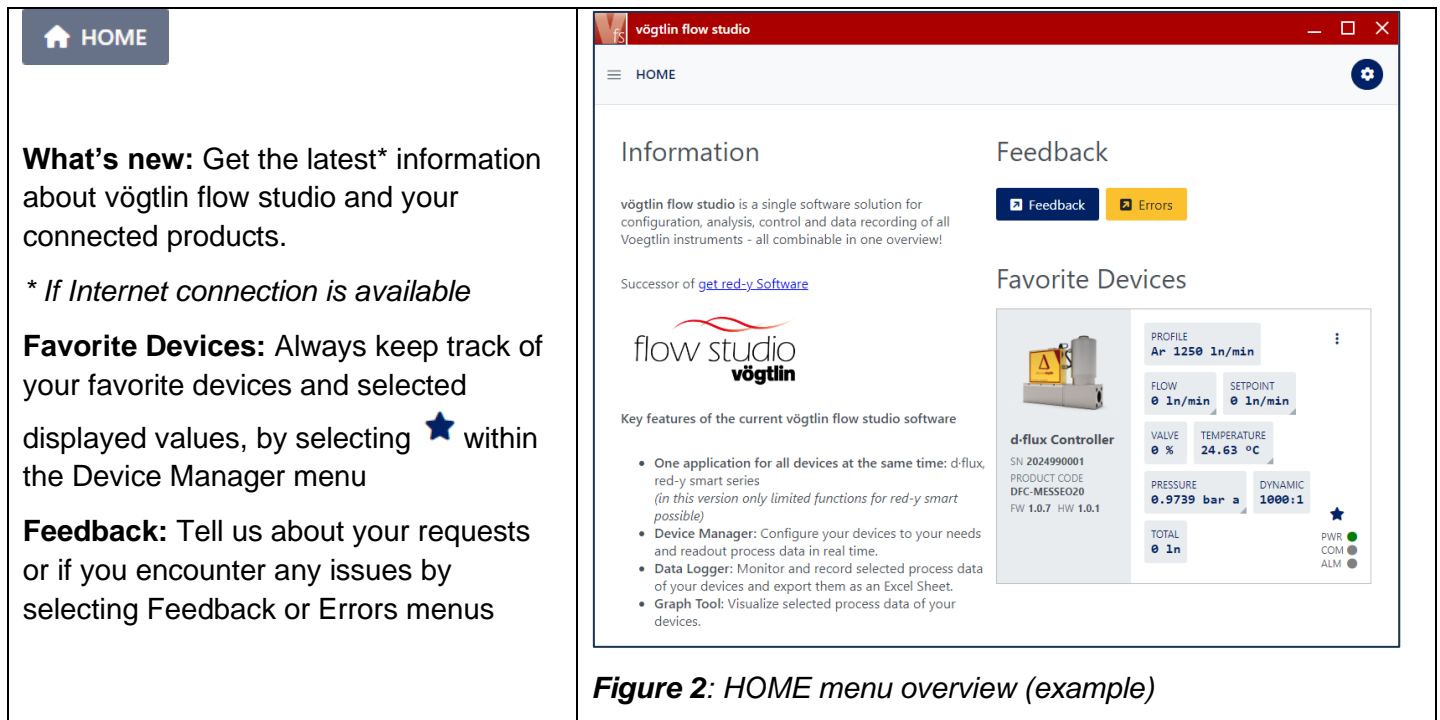

**Figure 1.1:** menu bar by large window size

## 3.2 Home Menu

**Get informed:** Get the latest news about vögtlin flow studio and your connected products

**Talk to us:** Tell us about your requests or if you encounter any issues

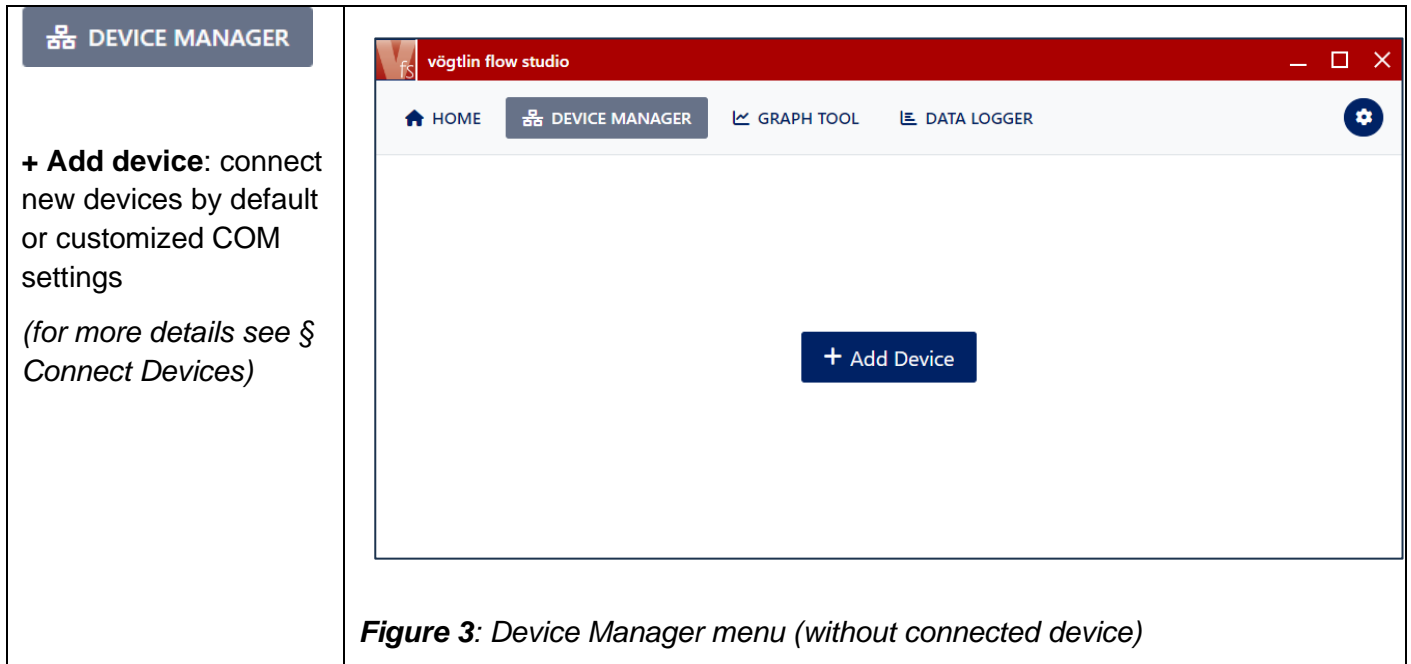

**Figure 2:** HOME menu overview (example)

### 3.3 Device Manager Menu

**Device List:** View all connected devices along with their status and details.

**Managing Devices:** Add, remove, or configure devices and manage their settings for optimal performance.



Once your devices are connected

Rearrange devices view

Search Device by S.N. or Product Code name

Edit status by double clicking graph and reset warnings e.g.

Device Parameters

Define as Favorit

Dedicated information (e.g. new available Firmware ...)

Edit Graph by double click Device Icon

Set the new value by double-clicking in fields showing this symbol

The screenshot shows the 'vögtlin flow studio' window with a 'DEVICE MANAGER' tab. It features a '+ Add Device' button and a search bar. Two devices are listed:

- d-flux Controller**: SN 2024990001, PRODUCT CODE DFC-MESSEO20, FW 1.0.7, HW 1.0.1. Parameters include PROFILE (Ar 1250 l/min), FLOW (0 l/min), SETPOINT (0 l/min), VALVE (0 %), TEMPERATURE (26.72 °C), PRESSURE (0.9744 bar a), DYNAMIC (1000:1), and TOTAL (0 l/min).
- red-y smart Controller**: SN 182455, PRODUCT CODE GSC-B9SA-BB23, FW 6.0.12, HW 6.0.0. Parameters include LUT (Air 3.233 l/min), FLOW (0 l/min), SETPOINT (0 l/min), VALVE (0 %), TEMPERATURE (31.25 °C), DYNAMIC (360:1), and TOTAL (2.13 l/s).

A tooltip is shown for the 'SETPOINT' field of the red-y smart Controller, displaying '2.1' and 'l/s/min' with a plus icon.

Figure 3.1: Device Manager menu (example)



## 3.4 Graph Tool Menu

**Creating Graphs:** Select and combine Device(s) data you want to visualize

**Customizing Graphs:** Adjust graph settings such as time scales, colors, and labels axis to suit your needs.

**GRAPH TOOL**

Combine devices and their signals on the same graph

At example Figure 4, we show the temperature of the two devices, in a minimum settings action of 4 steps.

- 1 Select your device
- 2 Select the signal you wish to display
- 3 Add the signal to the graph
- 4 Display the result

Device	Signal	Minimum	Maximum	Axis	Color
d-flux Meter 2021220008	Temperature	0	100	Left	Yellow
red-y smart Controller 182455	Temperature	0	100	Left	Red

**Figure 4:** Graph Tool menu showing the temperature of two devices (example)

## 3.5 Data Logger Menu

**Defined Data Logs:** Select, combine and collect device(s) data to log,

**Exporting Data:** Export logged data in Excel format for further analysis. *(more formats will be made available in the upcoming vögtlin flow studio releases)*

Monitor and record selected signal data from your devices and export them in Excel format.

At example Figure 5, we record any errors or warnings from the device by a time interval of one second, in a 5 steps action.

**DATA LOGGER**

5

Number of samples: 161

Timestamp	Device	Signal	Logged Value
4.9.2024, 13:03:58.363	d-flux Controller 2024990001	Errors Warnings	0 0
4.9.2024, 13:03:57.363	d-flux Controller 2024990001	Errors Warnings	0 0
4.9.2024, 13:03:56.363	d-flux Controller 2024990001	Errors Warnings	0 0
4.9.2024, 13:03:55.363	d-flux Controller 2024990001	Errors Warnings	0 0
4.9.2024, 13:03:54.364	d-flux Controller 2024990001	Errors Warnings	0 0

**Settings**

Device 1 Signal 2 Interval 3

Select Select Select

+ Add to logger 4

Device	Signal	Interval
d-flux Controller 2024990001	Errors Warnings	1 s

**Figure 5:** Data logger menu (example)

## 4. Connect Devices in two steps

**Step 1:** Use a COM port to establish a connection between your device and the software.



Per default vögtlin flow studio will always check All COM (serial) ports for you.



**Only for Advanced users and in case you use several COM ports:**

Reduce the device search time by selecting a **dedicated COM port**, within the modbus settings of vögtlin flow studio (as shown at **Figure 7**)

For that, find out which COM port is active in your configuration by using either solution **A** or **B**

**A:** using **Windows Device Manager**.

You can open the Windows Device Manager from the Windows Start menu

### Windows Device Manager

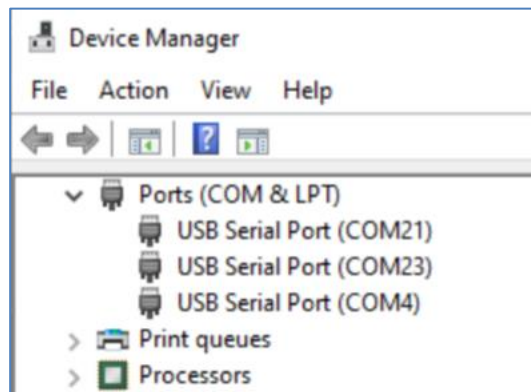

**Figure 6:** Windows Device Manager for the recognition of the correct COM port

## B: within **Search Settings** of **vögtlin flow studio**

Within *vögtlin flow studio* open **Device Manger** menu, select **+Add Device**, and the setting Icon. 

1 Within **Search Settings** click **Add Setting +MODBUS**.

2 Within the **MODBUS** window, open **All COM Ports** field

3 Current available COM ports will be displayed

### Search Settings of *vögtlin flow studio*

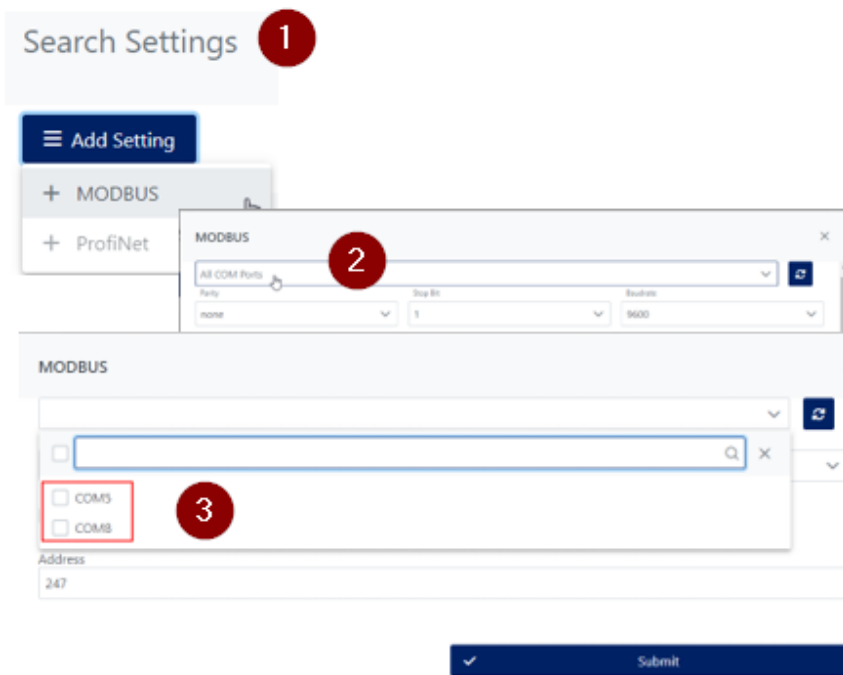

**Figure 7: Recognition of the correct COM port**

 click to refresh the view after any connection change



### When using solution A or B:

Remove the PDM-U or USB-RS485 adapter from your current connection setup. This will update the active COM ports in the Device Manager.

The COM port that is removed from the list is the port that you must select in the connection parameters. Reconnect the USB-RS485 adapter to the same location.



**Note:** within *vögtlin flow studio*, after you connect or remove any USB-RS485, do not forget to refresh the view by clicking the refresh button.

## Step 2: Add Devices to vögtlin flow studio

- C- Add Devices using default Manufacturer settings
- D- Add Devices using advanced and customized search settings



The software will automatically recognize connected devices and list them in the Device Manager.

## Add devices within the Device Manager

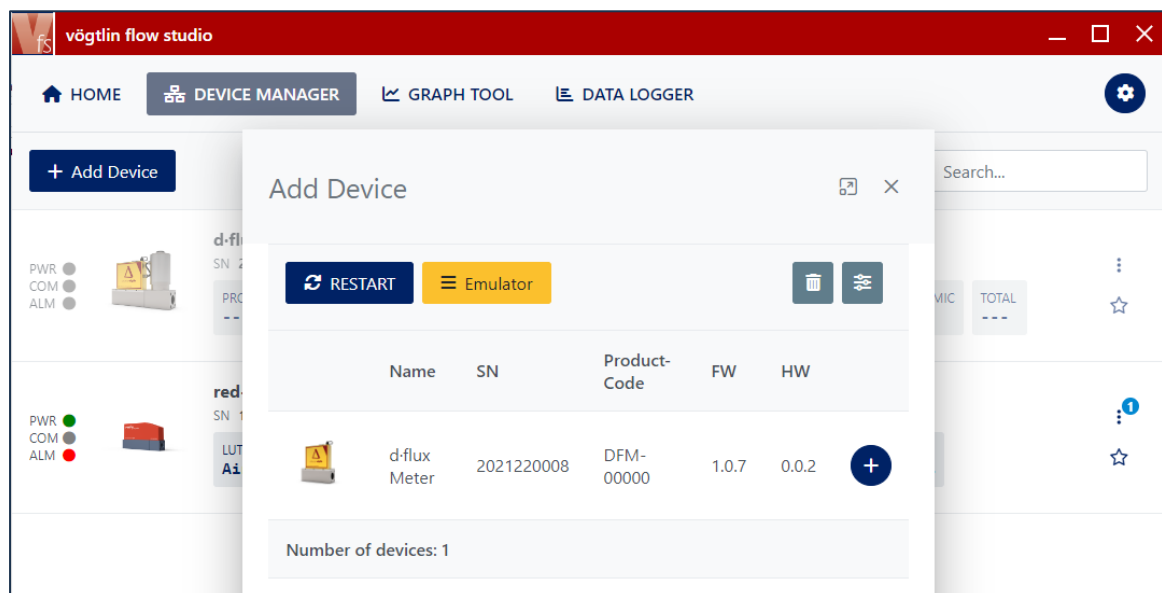

**Figure 8:** Add Device menu within Device Manager (example showing other d-flux devices to be added)

## C: Device connection using the manufacturer's default settings

within  **DEVICE MANAGER** 1

Click to  2

and  3

**Default production Modbus settings**, such as:  
*All COM ports, address 247, baud 9600, parity: None or Even\**  
will be used to find and list your device(s)

 \* Vögtlin devices like red-y family and d-flux from FW V1.08 use the Modbus parity "None" by default.

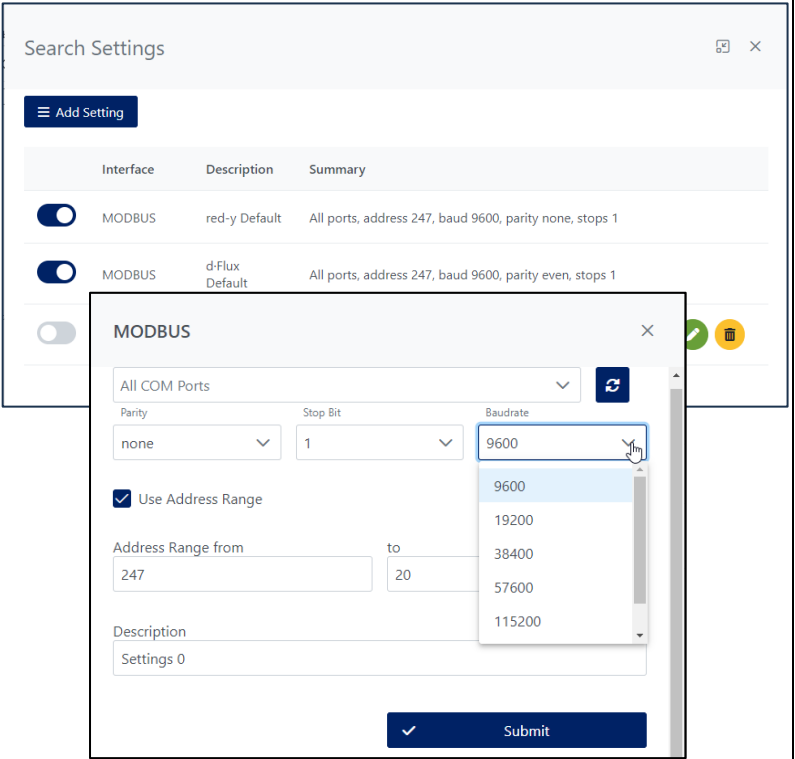

**Figure 9:** Start search device per default, will use manufacturer Modbus RTU settings

## D: Add Advanced and customized search settings

 **Add Advanced and customized search settings**

Within the menu **Add Device**, select this  Icon, to add your customized Modbus RTU Settings.



**Figure 10:** within Search Settings add your Modbus customized Settings

## 5. Updating of vögtlin flow studio

We regularly release new features and bug fixes.

Vögtlin flow studio notifies you when a new version is released and can be updated directly from within the software.



If the current version is out of date, a download icon will appear\* in the top right corner of the window.

(\* If an Internet connection is available)



To read what will change in the new version, select the Info icon within the update window.

To update vögtlin flow studio, select the download button.

A confirmation screen will appear asking if you wish to update immediately or at software shut down.

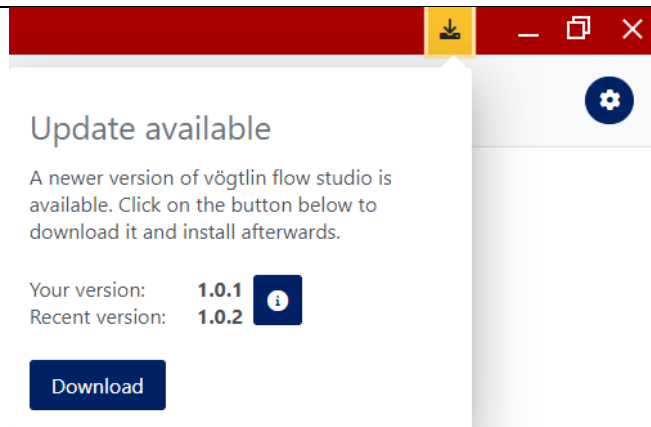

**Figure 11:** update menu by selecting the download icon (example)

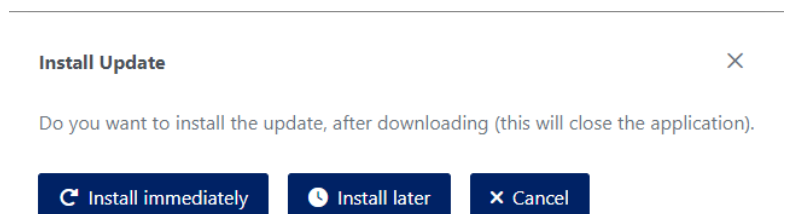

**Figure 12:** after you clicked "Download "

Version	1.0.1
Revision	25880dd6beef7eb
Release Notes	<a href="#">Show</a>

**Figure 13:** software version & release notes information available over the software settings by 

# 6. FAQs and troubleshooting

## 6.1 Windows Defender blocks installation

Windows Defender may give a warning about untrusted application and disallow further installation of vögtlin flow studio.

This message is related to a new code signing certificate used to sign vögtlin flow studio executable. Windows Defender will stop showing the message once it "knows" enough copies of vögtlin flow studio around the world.

If SmartScreen security level is set to "Warn", just click "More info" and then click "Run anyway".

If SmartScreen is set to level "Block" there will be no button to run the installation. In this case, open the properties of the downloaded exe file, and check "Unblock", apply the change and run the exe again.

# 7. Appendix

## 7.1 Copyright and Liability Disclaimer

All rights reserved. No part of this publication may be reproduced in any form or by any means without the publisher's prior written permission.

The content of this manual is provided for information only and may be altered without prior notice. Vögtlin Instruments GmbH assumes no responsibility or liability for any errors or inaccuracies in this document.

## 7.2 Contact information

If you have suggestions or encounter issues, please send them via the Feedback or Error menus. Use the 'Feedback' or 'Error message' forms in the home or settings menu.

We greatly appreciate your input, which helps us improve vögtlin flow studio.  
Thank you for using our software.

Find also your local Vögtlin sales partner on our website: [www.voegtlin.com](http://www.voegtlin.com)



## 7.3 History change document

Date	Version	Replaces	FW	Author	Note
24.09.2024	V1.0			D.HAE	Release of QSG